

Reflector Solutions

A Guide to Completing your Philips Fortimo LED Light Modules



Philips Fortimo light engine modules address the needs of many lighting applications. They are designed for ease of integration into new or existing luminaires and deliver high quality illumination with enough lumens to compete with conventional alternatives. In order to make the Fortimo LED module systems more easily accessible to all luminaire manufacturers, Philips Lighting and Future Lighting Solutions have engaged with complementary partners who have developed reflectors specifically for the Fortimo LED systems.



Philips Fortimo System					
Fortimo LED DLM	Part#	Fortimo LED Driver	Part#	Fortimo LED Cable	Part#
Product Description		Product Description		Product Description	
Module1100 19W/830UL	929000498303	120-277V 0-10V Dim	913701213402	500MM	442240066181
				840MM	442240072121
Module1100 18W/835UL	929000499603	120-277V 0-10V Dim	913701213402	500MM	442240066181
				840MM	442240072121
Module1100 17W/840UL	929000498403	120-277V 0-10V Dim	913701213402	500MM	442240066181
				840MM	442240072121
Module2000 36W/830UL	929000498503	120-277V 0-10V Dim	913701213402	500MM	442240068381
				840MM	442240072121
Module2000 34W/835UL	929000499703	120-277V 0-10V Dim	913701213402	500MM	442240068381
				840MM	442240072121
Module2000 33W/840UL	929000498603	120-277V 0-10V Dim	913701213402	500MM	442240068381
				840MM	442240072121

Alux-Luxar GmbH & Co.KG (www.alux-luxar.com) is the leading aluminum reflector manufacturer in the lighting industry, offering concept, design, and prototyping; they also specialize in LEDs and new energy efficient light sources.

Features

- Different beam angles for all applications
- State-of-the-art optic design
- Innovative Preano®LED technology
- Green technology due to thin material and high efficiencies



Pre-anodized



Post-anodized

Benefits

- Easy to adapt for all Fortimo systems
- Reduced energy consumption
- Committed to best quality and ultra high efficiency
- Continuous development of further optics
- Strong focus on Research and Development

FLC - Reflectors for all Philips Fortimo & Lexel LED DLM

Recommended Solution

2 x 35° - FLC 100

- LOR 97%
 - Material: Miro 4 Silver
 - Surface: Specular
- H : 75mm D1: 83mm
D2: 105mm D3: 125mm
with fixation assembled

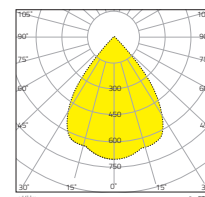
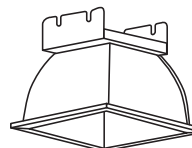
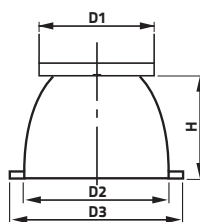
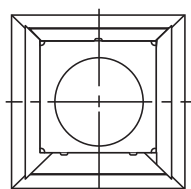

2 x 32° - FLC 200

- LOR 93%
 - Material: Miro 20 Silver
 - Surface: Diffuse
- H : 103mm D1: 83mm
D2: 112mm D3: 132mm
with fixation assembled

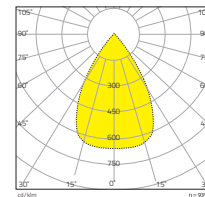
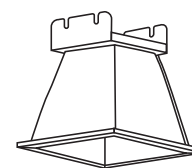
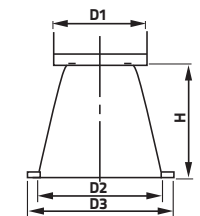
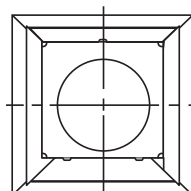

2 x 35° - FLC 600

- LOR 88%
 - Material: Clad Aluminum
 - Surface: Specular
- H : 72mm D3: 64mm
D1: 105mm D2: 125mm

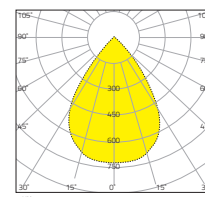
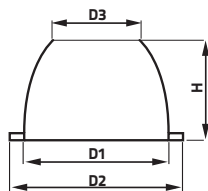
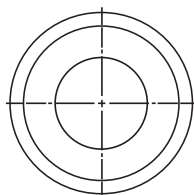

2 x 20° - FLC 700

- LOR 92%
 - Material: Clad Aluminum
 - Surface: Sandblasted
- H : 114mm D3: 67mm
D1: 180mm D2: 192mm

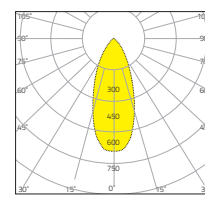
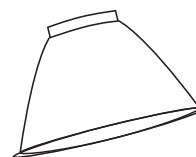
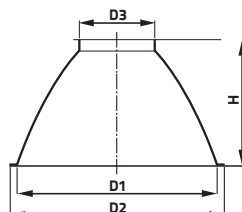
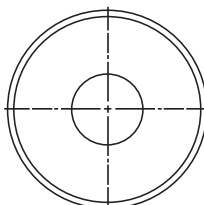

For a complete list of Philips Fortimo DLM products, please visit www.FutureLightingSolutions.com/Fortimo